

**IMPORTANT INFORMATION**  
 Dimensions to be confirmed on site prior to start of works and CDAS is to be informed of discrepancies immediately. No dimensions to be taken from this drawing.  
 All materials and works are to be carried out in accordance with current British Standards, Planning Approval, current Building Regulations and Codes of Practice.  
 Party Wall Act -  
 Notices under the Party Wall Act are to be served by the property owner or appointed third party by property owner.  
 Health and Safety -  
 CDM 2015 Regulations apply to all construction works to be carried out and apply to designers, contractors and the client. As such all parties have duties under these regulations.

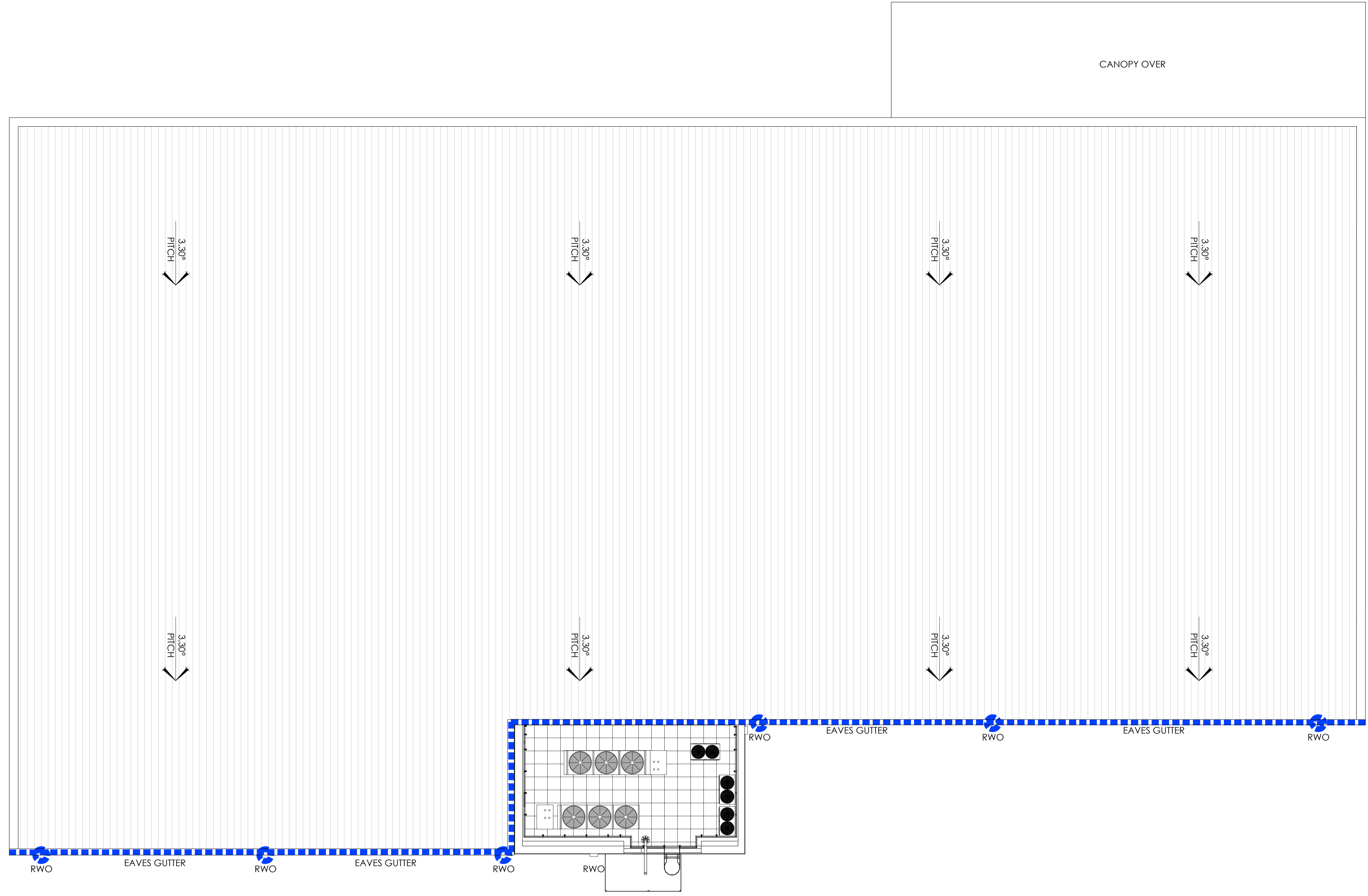
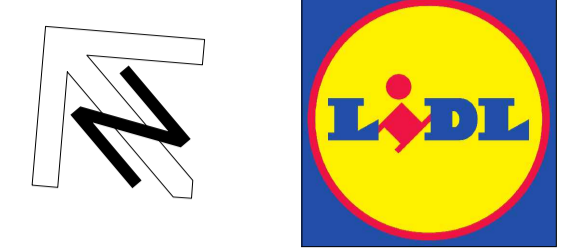

Rev	Date	Description	Revised By	Checked By
		Amendments		

**STATUS: PLANNING**

**Client**  
 LIDL UK GMBH - WESTON-SUPER-MARE, BS24 7TG

**Project**  
 LAND ADJACENT TO LORDS HILL, PYART COURT, COLEFORD

**Title**  
 PROPOSED ROOF PLAN

Job No. 17169  
 Drawing No. AD 112  
 Drawn by SEN  
 Checked by DGH  
 Date SEP 2018  
 Scale 1:100  
 Sheet A1

**ONE DESIGN**  
 ARCHITECTURAL SERVICES

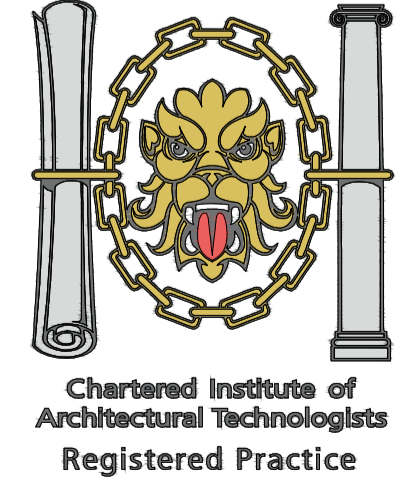

Chartered Institute of Architectural Technologists  
 Registered Practice  
 One Design Architectural Services Ltd  
 Unit 1, Merchants Quay,  
 Phase II, Ashley Lane, Shipley  
 West Yorkshire, BD17 7DB  
 01274 591188  
 www.onedesignarchs.com  
 mail@onedesignarchs.com

